



⚠️ WARNING

Read and understand this entire instruction manual before using this stove. Keep this instruction manual for future reference. Practice using this stove before heading out on your trip to familiarize yourself with its function and dangers. If you do not understand this manual or have any questions, please call GSI Outdoors, Inc. at **1-800-704-4474, +1-509-928-9611**, email us at info@gsioutdoors.com or visit our website at www.gsioutdoors.com.

Do not attempt to use this stove: (1) before reading and fully understanding this instruction manual; (2) if you are not prepared or comfortable attending to a burning and/or hot stove at all times; (3) if you observe, smell or hear leaking fuel; or (4) if you observe any condition with the stove system or in the surrounding environment that would make operation of an open flamed device dangerous. Failure to follow these directions can cause an unsafe situation leading to fire or an explosion, resulting in serious bodily injury or death.

⚠️ IMPORTANT

Do not use stove if parts are missing or broken, or with replacement parts not specific to your stove model. Use of stove with missing or broken parts, or with replacement parts not specific to your stove model, can result in burns severe injury or death.

Do not attempt to modify or use this stove in any way for any purpose other than described in this instruction manual

⚠️ FOR YOUR SAFETY

IF YOU SMELL GAS:
1/ Do not attempt to light appliance.
2/ Extinguish any open flame.
3/ Disconnect from fuel supply.

Do not store or use gasoline or other liquids with flammable vapours in the vicinity of this or any other appliance.

⚠️ SAFETY INFORMATION

This stove is designed for **OUTDOOR USE ONLY** for boiling water and cooking food. Use of stove within any enclosed space, or for a purpose other than boiling water or cooking food can cause fire, explosion or poisoning resulting in serious bodily injury or death. You are responsible for your own safety and the safety of those around you. This manual is not intended to replace your good judgment. If you have any questions or concerns contact GSI Outdoors, Inc. at **1-800-704-4474, +1-509-928-9611**, email us at info@gsioutdoors.com or visit our website at www.gsioutdoors.com.

PARTS

a: Flame Adjuster b: Flame Adjuster Valve c: Valve Body Pot d: Burner Head e: Support Arms f: Fuel Line g: Stove Legs

⚠️ WARNING

Handling the brass material on this product exposes you to lead, a chemical known to the State of California to cause cancer, birth defects or other reproductive harm.
WASH YOUR HANDS AFTER HANDLING THIS PRODUCT

⚠️ DANGER

⚠️ DANGER CARBON MONOXIDE HAZARD
This appliance can produce carbon monoxide which has no odor. Using it in an enclosed space can kill you. Never use this stove in an enclosed space such as a camper, tent, car or home.

IGNITION HAZARD
 This stove can easily ignite surrounding materials and flammable liquids or vapors. Keep stove and cartridge away from other heat sources. If you determine that a windscreen is needed use **ONLY** the GSI Outdoors Pinnacle Windscreens that are designed for exclusive use with the GSI Outdoors Pinnacle Stoves in their prescribed fashion.

INJURY HAZARD
 Never let children use this stove. Supervise children in the cooking area at all times, keeping them at least 10 feet (3+ meters) away from the stove.

⚠️ GENERAL FUEL CARTRIDGE SAFETY

This stove uses a liquid pressurized gas (LPG) cartridge that is highly flammable and explosive. Use only GSI Outdoors isoButane Fuel Cartridges of Isobutane and Propane mix (4 oz./110 g or 8 oz./230 g). Because GSI Outdoors cannot assure the quality and safety of other manufacturers' fuel cartridges, do not attempt to fit other types or makes of gas cartridges to the Pinnacle Stove. Follow this safety information when using GSI cartridges:

!/ Listen and smell for leaking gas. Leaking gas is a serious hazard. Natural LPG is invisible and odorless; strong odorant additives have been added to the fuel mix but can fade over time. Leaks are not always detectable by smell. Do not use this stove if it is leaking, damaged, or does not operate properly.

!/ Check that the stove and fuel cartridge connection is secure and tight. If the connection does not look or feel secure, or if you hear or smell leaking gas, do not use stove or cartridge. Move stove to a well-ventilated area away from any ignition source to locate and stop the leak. Only check for leaks outdoors using soapy water. Bubbles will form if the soapy water is poured over a leak. Do not try to detect leaks using a flame.

⚠️ GENERAL FUEL CARTRIDGE SAFETY

!/ Only change the cartridge outside and at least 25 feet (7.6 meters) from people and any source of ignition.

!/ Always position stove on a stable, solid level surface before using stove. Check and if necessary clean the seals for dust, proper seating or any wear before connecting a new fuel cartridge to the stove. Do not use stove if seals are damaged or worn.

!/ Keep stove and fuel cartridge at least 25 feet (7.6 meters) away from other heat sources. If you expose the fuel cartridge to high heat, the cartridge will explode or leak resulting in serious bodily injury or death. This stove can ignite combustible materials, flammable liquids and vapors creating a situation where fire, burns severe injury or death can result.

!/ Follow all warnings on fuel cartridges regarding use and storage.

WARRANTY

LIMITED WARRANTY/LIMITATIONS OF REMEDIES AND LIABILITY
 USA, Canada and other applicable Countries

Limited Warranty :
 GSI Outdoors, Inc. USA (GSI Outdoors) to the original owner ("Owner"), under intended use and maintenance, warrants the enclosed product ("Product") to be free from defects in materials and workmanship for the life of the Product. No warranty against defects in materials and workmanship will apply if Product is (i) altered in any way, (ii) used for purposes inconsistent with Product's intended purpose or design, or (iii) improperly maintained. Warranty will furthermore be voided where Owner/user (i) failed to follow Product instructions or warnings or (ii) subjected Product to misuse, abuse, or neglect.

EXCLUDING THE LIMITED WARRANTY PROVIDED ABOVE, GSI OUTDOORS, INC., ITS AFFILIATES AND THEIR SUPPLIERS, TO THE MAXIMUM EXTENT PERMITTED BY LAW, MAKE NO WARRANTIES, EXPRESSED OR IMPLIED, AND DISCLAIM ALL WARRANTIES, DUTIES AND CONDITIONS, WHETHER EXPRESSED, IMPLIED OR STATUTORY, WITH RESPECT TO THE PRODUCT, INCLUDING WITHOUT LIMITATION ANY IMPLIED WARRANTIES OF MERCHANTABILITY, AGAINST LATENT DEFECTS, FITNESS FOR A PARTICULAR PURPOSE, OR CORRESPONDENCE TO DESCRIPTION.

WARRANTY

During the warranty period, original product parts determined by GSI Outdoors, Inc. to be defective in materials or workmanship will be repaired or replaced as Owner's sole remedy. GSI Outdoors, Inc. reserves the right to replace any discontinued product with a new product of comparable value and function. A returned Product deemed irreparable becomes the property of GSI Outdoors, Inc. and will not be returned.

Warranty Service. To obtain service under this warranty, the warranty-eligible Product must be presented to GSI Outdoors, Inc. by calling 1-800-704-4474 [M-F, 8:00-4:30, PDT] or emailing info@gsioutdoors.com. Owner is responsible for all costs associated with returning Product to GSI Outdoors for service. Where at its sole discretion GSI Outdoors deems Product eligible for warranty repair or replacement, GSI Outdoors will pay the shipping and handling associated with returning repaired or replaced Product to Owner. In instances where GSI Outdoors deems a returned product ineligible for warranty service, GSI Outdoors will, if possible, repair products for a reasonable charge that includes return shipping and handling. For warranty return service details, please go to www.gsioutdoors.com.

WARRANTY

Limitation of Remedies. Should a court of competent jurisdiction find the limited warranty set forth above breached, GSI Outdoors' only obligation will be to, at its option, either repair or replace Product. Should the aforementioned remedy fail of its essential purpose, GSI Outdoors will, in exchange for return of Product, refund to Owner Product's original purchase price. **THE FOREGOING REMEDY IS THE SOLE AND EXCLUSIVE REMEDY OF THE PURCHASER AGAINST GSI OUTDOORS, ITS AFFILIATES AND THEIR SUPPLIERS, REGARDLES OF LEGAL THEORY.**

Limitation of Liability. GSI Outdoors', its affiliates' and their suppliers' maximum liability is limited to incidental damages not to exceed the original purchase price of the Product. GSI OUTDOORS, ITS AFFILIATES AND THEIR SUPPLIERS HEREBY DISCLAIM AND EXCLUDE ANY REASON WHATSOEVER. THIS EXCLUSION AND LIMITATION APPLIES TO ALL LEGAL THEORIES UNDER WHICH DAMAGES MAY BE SOUGHT, AND WILL APPLY EVEN IF ANY REMEDY FAILS OF ITS ESSENTIAL PURPOSE.

WARRANTY

This limited warranty gives Owner specific legal rights; Owners may have additional rights, which may vary state to state.

Always completely follow safety, use operation, and maintenance instructions for this or any other GSI Outdoors product. European Union customer statutory rights are not affected.

GSI Outdoors, Inc.
 For product service and information contact GSI Outdoors, Inc. USA
 1023 S. Pines Road, Spokane WA. 99206 USA
 1-800-704-4474 or 509-928-9611
www.gsioutdoors.com

KNOW YOUR STOVE BEFORE YOU GO!

Familiarize yourself with the parts of your GSI Outdoors Pinnacle 4 Season Stove and the instructions for use and storage before connecting the stove to its fuel cartridge. Never use this stove in any other way than is described in the following instructions. For more information or videos on how to use the GSI Outdoors Pinnacle 4 Season Stove visit our website at www.gsioutdoors.com.

CSA US **Nominal Heat Input Rate:** 7,829 BTU/h.

CE 0359-16 (51CL3921-2010) 2009/142/EC
Nominal Heat Input Rate: 2.29 kW 167 g/h.

Clearance to combustibles: top 4 ft. (1.2 m), sides 4 ft. (1.2 m)
 *Nominal Heat Input Rate varies depending on test procedures of the particular standards agency.

#56003: Pinnacle® 4 Season Stove
 © 2015 GSI Outdoors, Inc.
 1023 S Pines Rd Spokane WA 99206 USA
 PO Box 132 Wakefield, England WF1 1XJ
GSIoutdoors.com

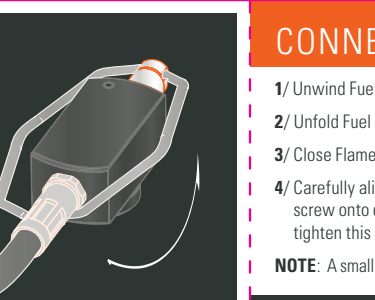
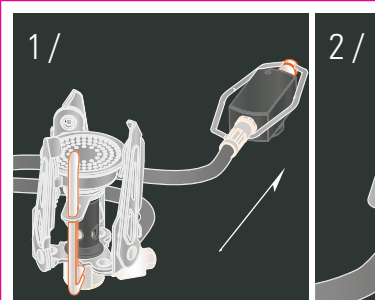

CONNECTING STOVE AND CARTRIDGE

- 1/ Unwind Fuel Line and Valve Body.
- 2/ Unfold Fuel Adjuster.
- 3/ Close Flame Adjuster Valve (clockwise rotation).
- 4/ Carefully align the Flame Adjuster Valve body with the fuel cartridge nipple and screw onto cartridge (clockwise) until connection is secure. Do not attempt to tighten this connection with any tool.

NOTE: A small amount of gas may escape when connecting or disconnecting fuel cartridge

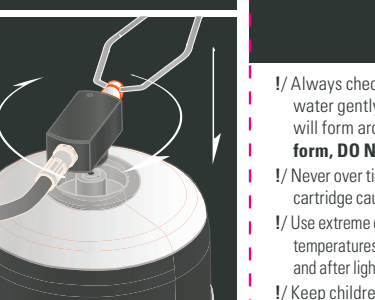
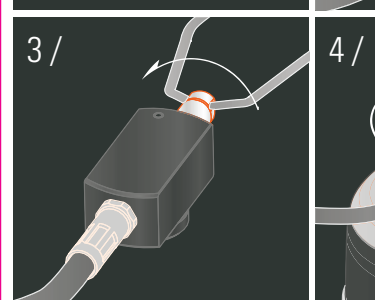

⚠ DANGER

- ! Always check for leaks after installing the fuel cartridge. If in question, pour soapy water gently over the suspected area(s) of the stove and fuel cartridge. Bubbles will form around leaking areas. **DO NOT TEST WITH FLAME. If any bubbles form, DO NOT USE the fuel cartridge.**
- ! Never over tighten fuel cartridge to stove. Over tightening can damage stove or cartridge causing fuel to leak. Leaking fuel can cause fire, burns, severe injury or death.
- ! Use extreme caution when using stove in temperatures below freezing. In freezing temperatures O-rings can become hard and leak fuel. Always check for fuel leaks before and after lighting stove. Use of a leaking stove can cause fire, burns, severe injury or death.
- ! Keep children and pets at least 10 feet (3+ meters) away from the stove.

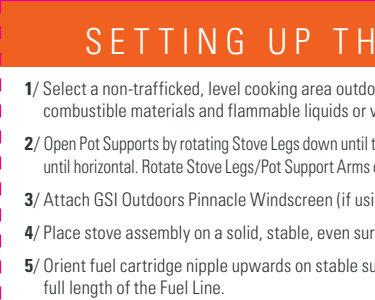
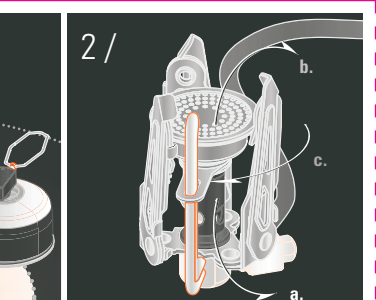

SETTING UP THE STOVE

- 1/ Select a non-trafficked, level cooking area outdoors and clear cooking area of combustible materials and flammable liquids or vapors.
- 2/ Open Pot Supports by rotating Stove Legs down until they stop. Rotate Pot Support Arms up until horizontal. Rotate Stove Legs/Pot Support Arms out from Burner Head until they stop.
- 3/ Attach GSI Outdoors Pinnacle Windscreen (if using).
- 4/ Place stove assembly on a solid, stable, even surface to ensure stability.
- 5/ Orient fuel cartridge nipple upwards on stable surface away from the stove at the full length of the Fuel Line.

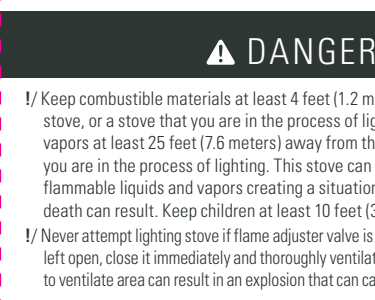
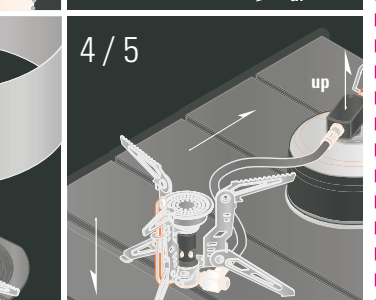

⚠ DANGER

- ! Keep combustible materials at least 4 feet (1.2 meters) away from the burning stove, or a stove that you are in the process of lighting. Keep flammable liquids and vapors at least 25 feet (7.6 meters) away from the burning stove, or a stove that you are in the process of lighting. This stove can ignite combustible materials, flammable liquids and vapors creating a situation where fire, burns severe injury or death can result. Keep children at least 10 feet (3+ meters) away from the stove.
- ! Never attempt lighting stove if flame adjuster valve is left open. If flame adjuster valve is left open, close it immediately and thoroughly ventilate area before lighting stove. Failure to ventilate area can result in an explosion that can cause fire, burns, severe injury or death.

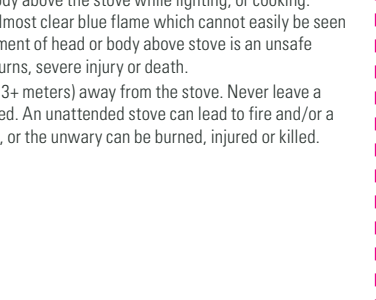
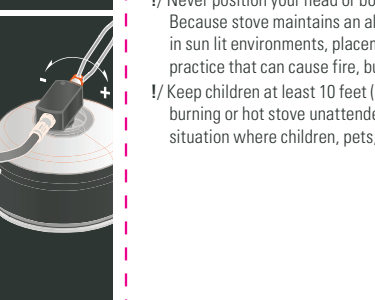
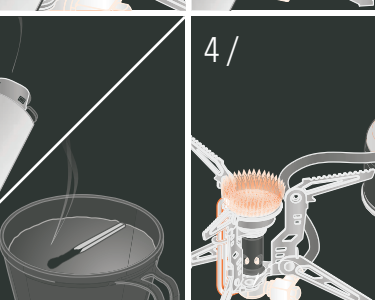
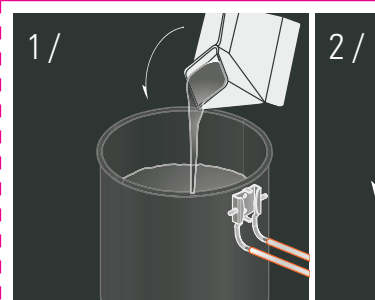
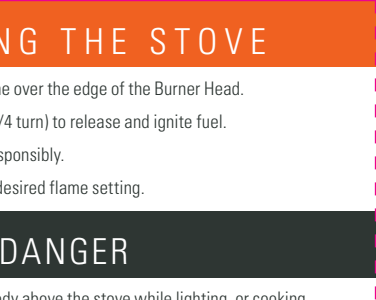
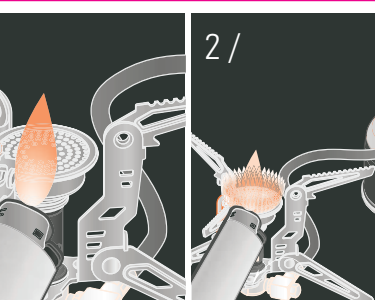

⚠ DANGER

- ! Never position your head or body above the stove while lighting, or cooking. Because stove maintains an almost clear blue flame which cannot easily be seen in sun lit environments, placement of head or body above stove is an unsafe practice that can cause fire, burns, severe injury or death.
- ! Keep children at least 10 feet (3+ meters) away from the stove. Never leave a burning or hot stove unattended. An unattended stove can lead to fire and/or a situation where children, pets, or the unwary can be burned, injured or killed.

LIGHTING THE STOVE

- 1/ Hold a lit match or lighter flame over the edge of the Burner Head.
- 2/ Open Flame Adjuster Valve (3/4 turn) to release and ignite fuel.
- 3/ Extinguish match or lighter responsibly.
- 4/ Turn Flame Adjuster Valve to desired flame setting.

⚠ DANGER

- ! Never position your head or body above the stove while lighting, or cooking. Because stove maintains an almost clear blue flame which cannot easily be seen in sun lit environments, placement of head or body above stove is an unsafe practice that can cause fire, burns, severe injury or death.
- ! Keep children at least 10 feet (3+ meters) away from the stove. Never leave a burning or hot stove unattended. An unattended stove can lead to fire and/or a situation where children, pets, or the unwary can be burned, injured or killed.

USING THE STOVE TO COOK

- 1/ Add food or liquid to cookware.
- 2/ Place cookware onto the center of the stove.
- 3/ Turn Flame Adjuster Valve to adjust heat. (approx. 1/4 turn for optimum efficiency)

⚠ DANGER

- ! Never move a burning or hot stove. Always extinguish stove and cool before moving. Moving a burning or hot stove can cause fire, burns, severe injury or death.
- ! Never use any cookware with a diameter larger than 9.5 inches (24.2 cm) and height greater than 6 inches (15.2 cm) or stove-top ovens with a heat retention feature with this stove; doing so can cause the cartridge to explode resulting in serious bodily injury or death.
- ! Reflected heat can overheat the fuel cartridge. Never place and operate two or more stoves together. Never operate stove with empty or dry cookware. Use of stove in any of the proceeding manners can result in the fuel cartridge exploding and causing fire, burns, severe injury or death.
- ! Never use cookware that is not flat on the bottom. Use of stove with damaged and/or inappropriate cookware can result in cookware and/or stove instability resulting in a situation where hot cookware and/or cookware contents can easily spill causing fire, burns, severe injury or death.

USING THE STOVE IN LIQUID FEED MODE

- 1/ Follow instructions as described in "Connecting Stove And Cartridge", "Setting Up The Stove" and "Lighting The Stove".
- 2/ After burning for 30 seconds, reduce flame to minimum flame height and invert cartridge for improved performance in cold conditions.
- 3/ Turn Flame Adjuster Valve to adjust heat.

⚠ DANGER

- ! Never move a burning or hot stove. Always extinguish stove and cool before moving. Moving a burning or hot stove can cause fire, burns, severe injury or death.
- ! Never use any cookware with a diameter larger than 9.5 inches (24.2 cm) and height greater than 6 inches (15.2 cm) or stove-top ovens with a heat retention feature with this stove; doing so can cause the cartridge to explode resulting in serious bodily injury or death.
- ! Reflected heat can overheat the fuel cartridge. Never place and operate two or more stoves together. Never operate stove with empty or dry cookware. Use of stove in any of the proceeding manners can result in the fuel cartridge exploding and causing fire, burns, severe injury or death.

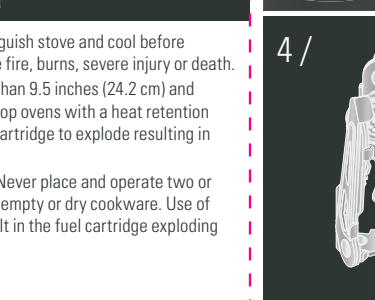
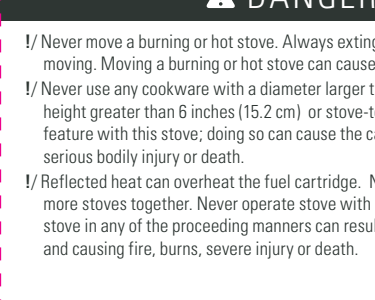
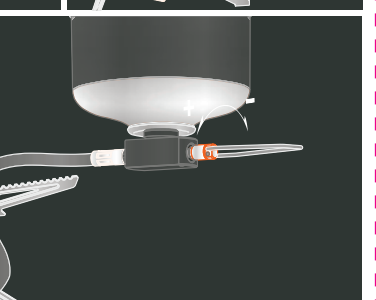
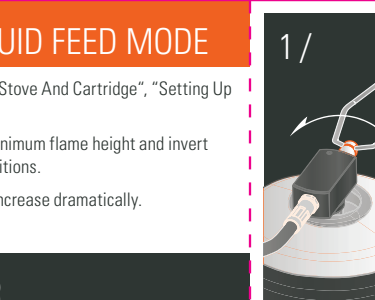
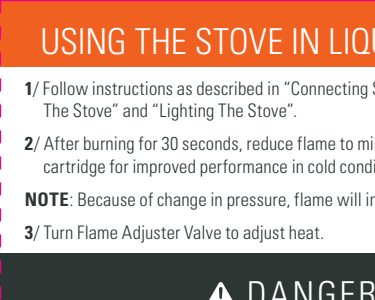
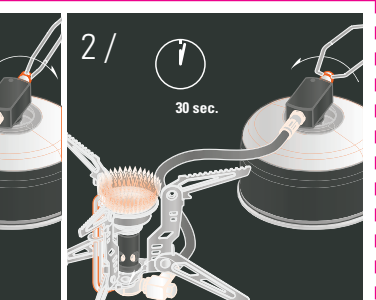

TURNING OFF THE STOVE

- 1/ Close Flame Adjuster Valve when cooking is done (clockwise rotation).
- 2/ After flames are out, wait 10 minutes for stove to cool.
- 3/ Move stove assembly away from any ignition sources and unscrew from cartridge by grasping the valve body (counter clockwise rotation).
- 4/ After the stove has completely cooled fold Flame Adjuster and close Pot Supports.
- 5/ Store in storage sack or a clean dry environment.

⚠ DANGER

- ! Stove and components will be VERY hot for a period of time after shutting off. Never attempt to remove or compact the stove while it is hot to the touch. Doing so can quickly result in severe burns and possible ignition of flammable materials.
- ! Always disconnect stove from cartridge before storing it. Failure to disconnect stove from cartridge before storing may cause fuel to leak and cause fire, burns, severe injury or death. Always store the fuel cartridges in a well-ventilated location, well away from any possible heat or ignition source such as: heaters, furnaces, water heaters, gas appliances or pilot lights. Storing fuel cartridges near any heat or ignition source or where temperatures exceed 120 F (49 C), can result in fire, explosion or poisoning resulting in serious bodily injury or death.